

# CAPSULE ASSEMBLY INSTRUCTIONS

## MODELS CC 250 CC450

### STEP ONE:

PLACE FEEDER BASE IN CENTER OF TIRE. USING HOLES PROVIDED, SECURE TO BASE WITH FOUR TIRE BOLTS.

**NOTE:** IF INSTALLING CF450 GREY EXTENSION; LINE UP SLOTS IN EXTENSION AND METAL STRAP WITH INSERTS IN BASE. SECURE WITH FOUR 3/8" WASHERS AND 1" BOLTS.

### STEP TWO:

PLACE DOME ON BASE OR EXTENSION AND LINE UP SLOTS WITH INSERTS IN BASE. PLACE METAL STRAP AROUND DOME FLANGE OR EXTENSION AND ALIGN SLOTS. USE A LARGE #3 SCREW DRIVER TO AVOID STRIPPING. SECURE WITH FOUR 3/8" WASHERS AND 1" BOLTS.

### STEP THREE:

RUN THE AUGER TUBE THROUGH THE HOLE IN TOP OF DOME AND SECURE WITH SELF TAPPING SCREW.

### STEP FOUR:

MOUNT CAGE TO DOME WITH FOUR 3/8" WASHERS AND 1" BOLTS.

### STEP FIVE:

SLIDE SPINNER ONTO AUGER SHAFT. SECURE AUGER SHAFT TO MOTOR WITH (1) METAL COUPLING AND (2) SAFETY PINS. **NOTE: METAL COUPLING WILL FIT LOOSE ON MOTOR SHAFT. THIS ALLOWS AUGER TO OPERATE FREELY AND CLEAR ITSELF IN THE EVENT OF DIRTY FEED.**

### STEP SIX:

POSITION AUGER AND MOTOR HOUSING IN PLACE. MOUNT MOTOR HOUSING TO CAGE USING (3) 1" BOLTS AND (3) 3/8" WASHERS.

### STEP SEVEN:

FEED SOLAR PANEL WIRES THROUGH HOLE IN MOTOR HOUSING CAP. LINE UP CORNERS OF SOLAR PANEL WITH THE FOUR KNOBS ON MOTOR HOUSING CAP. AND SECURE WITH (4) SOLAR PANEL SCREWS. SECURE MOTOR HOUSING CAP WITH (2) WING BOLTS.

### STEP EIGHT:

POUR FEED IN FILL HOLE. SECURE FILL CAP WITH (2) WING BOLTS.

### TOOLS NEEDED:

LARGE PHILLIPS SCREWDRIVER  
CORDLESS SCREWDRIVER

### HARDWARE

(10) 1" BOLTS  
(10) 3/8" WASHERS  
(4) LARGE TIRE SCREWS  
(1) SELF-TAPPING SCREW  
(4) SOLAR PANEL SCREWS  
(1) METAL COUPLING  
(2) SAFETY PINS  
(4) WING NUTS

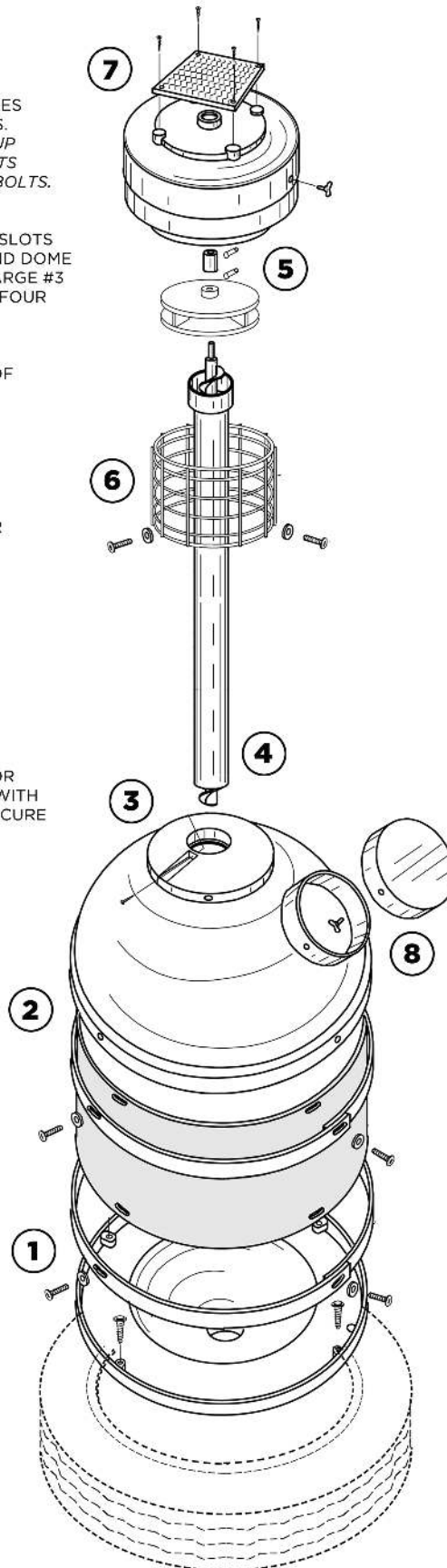

22" - 24" TIRE (NOT INCLUDED)