

ADJUSTABLE PERFORMANCE FEATURES

1. Variable click sear

The Tru-Fire Sear's defining feature is it's ability to give the user a choice between 4 different clicks; short (I), medium (II), long (III), and no click

2. Hot/Cold adjustment

Adjusts how quickly the user reaches the click

3. Interchangeable 3rd/4th finger

Easily converts from a 3-finger release to a 4-finger release

4. Sweeping 4th finger

Conforms to the users style and comfort by offering the ability to adjust the sweep angle of the 4th finger attachment up to 45 degrees

5. Multiple position thumb post

Allows the user to customize the thumb post position to one of three location for optimum comfort and feel

Magnet assist reset *

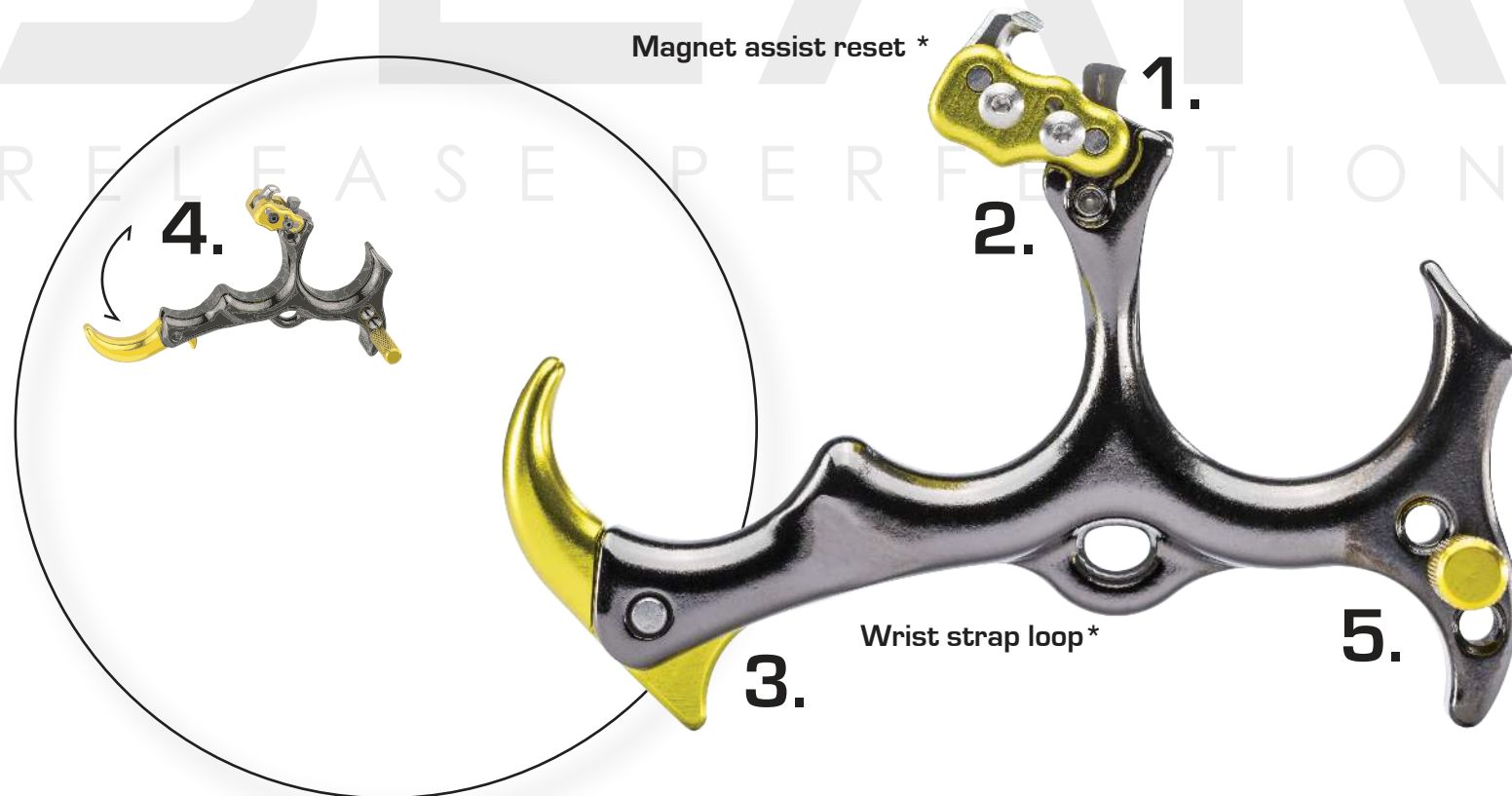

SEAR

RELEASE PERFECTION

Variable click sear

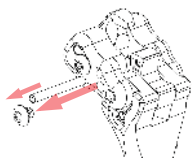

1. Using a .050" hex key, remove the button head screw that holds limiting pin in place. Remove the limiting pin.

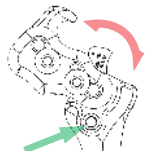

2. Using a 1/16" hex key, loosen the locking set screws on each side of the sear (green arrow). Once loose, rotate the sear to the desired location.

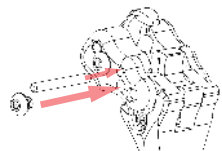

3. Tighten the two locking set screws in place, and replace the limiting pin and button head cap screw.

Note: Click setting is indicated by the marks on the sear (I, II, or III). The active click is the numeral immediately counterclockwise of the numeral shown. Example: If the numeral III is showing, II (medium click) is active.

Hot/Cold Adjustment

1. Using a 1/16" hex key, loosen the locking set screws on each side of the sear.



2. Rotate the sear to the desired hot/cold setting. Moving the sear clockwise in the view shown will make the release hotter, as indicated by the "HOT" lettering.

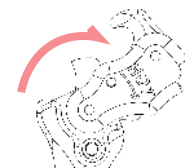

3. Tighten the locking set screws.

Note: Be sure to tighten the screws in a location that clamps on the sear, as it is possible to "miss" the sear with the set screws.



Interchangeable 3rd/4th finger

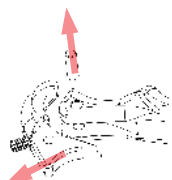

1. Using a 1/16" hex key, loosen the set screw and remove the pin as shown on left. Once the pin is removed, remove the 3-finger attachment.

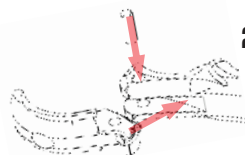

2. Insert the 4th finger attachment, and replace the pin as shown. Tighten down each set screw.

Sweeping 4th finger

1. Using a 1/16" hex key, loosen/tighten the two set screws to set the desired angle of the 4th finger attachment.

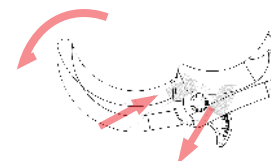

2. When the desired angle is reached, make sure each set screw is tight.

